



Kingfisher Lighting

A division of the LUCECO group

Datasheet

MIKO Wall



Specification Text

The MIKO Wall shall be manufactured from die-cast aluminium and powder coated with a graphite grey or aluminium silver finish. It shall have a power output of 10W, with an efficacy of up to 180.0 lm/W. It shall deliver 1,800 luminaire lumens. The MIKO Wall uses indirect light to illuminate the façade to create a comfortable illumination. Available in 3000K or 4000K, the luminaire shall be IK08 and IP66 rated.

Specification

Weight:	1.45kg
Material:	Die-cast Aluminium
Paint Finish:	Aluminium Silver

Product Description



MIKO is our stylish wall mounted fitting, offering a comfortable distribution. Pair with the MIKO Bollard and Grande for a uniform aesthetic.

Key Features

- 10.0W
- 1,800 Luminaire Lumens
- Efficacy of up to 180.0 lm/W
- 3000K, CRI>80
- IP66, IK09
- Lifetime > 60,000 hrs, L80

Optics

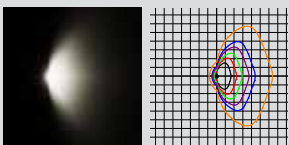

Radial

IP66	IK09	Colour Temperature		Anti-glare	
5 YEARS WARRANTY		60,000 hrs LIFETIME			

Other Options Available

Contact for further details

- Colour Temperature Opportunities

Mounting Options

- Wall Mounted

Body Type	A	B	C
Wall Mounted	200	100	76

All measurements in mm

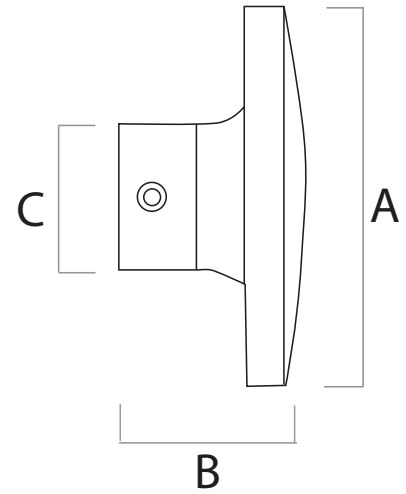

Code	Power (W)	Luminaire Lumens (lm)	Drive Current (mA)	Optic	CCT(K)	IP	IK	Weight (kg)	Driver Included	Driver Type
MIKW-SYR-830-10-21	10.0	1,800	-	Radial	3000	IP66	IK09	1.45	Yes	Fixed